

EC

45

Versatile system for most
residential design needs

Thermeco
Windows for meaningful living.

EC45

EC45 is Thermeco's most popular and adaptive system to suit Australia's broad and dynamic environmental conditions.

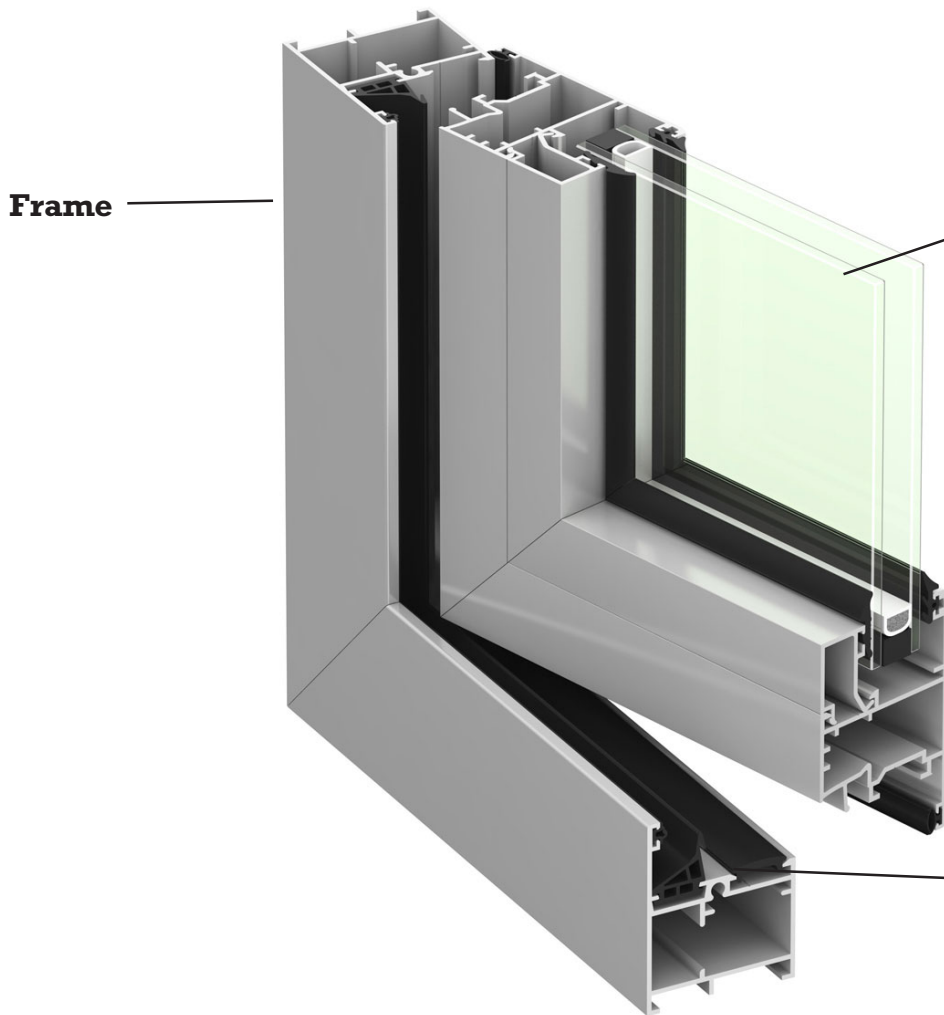
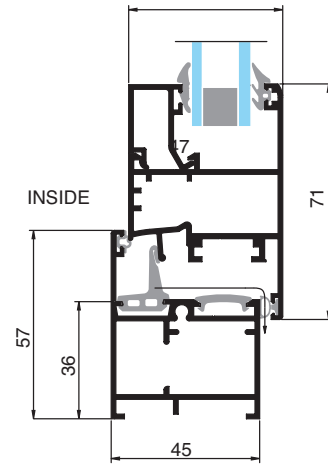

Single or Double Glazing

Excellent thermal & acoustic insulation available in a range of up to 30mm thickness to suit installation requirement.

Gasket

Made from EPDM provides initial protection for wind & water penetration.

Opening Styles

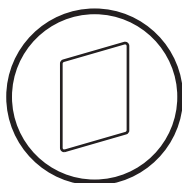

Fixed

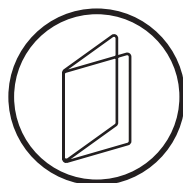

Casement

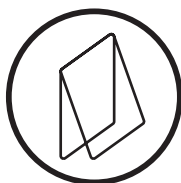

Awning

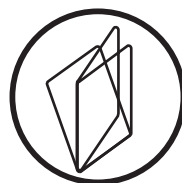

Turn & Tilt

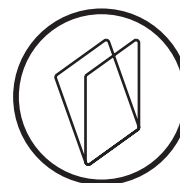

Tilt In

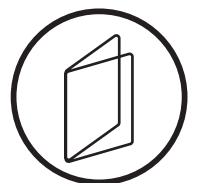

Hinged Doors

Style	Fixed	Casement		Awning		Turn & Tilt	Tilt In	Hinged Doors
		Standard	Savio OS	Standard	Savio OS			
Max Width	Various	1200	1200	1700	1700	1200	1500	1000
Max Height		2500	2700	2000	2000	2500	2200	3000
Max Weight (kg)		80	100	40	100	80	100	80



Design & Build: Englehart Homes



Architect: Gardiner Architects | Builder: Constructing Spaces



Architect: S. Group Official

Features & Benefits



Low maintenance



Maximum wind and water tightness



Increased airflow & greater ventilation control



Multi-position locking for added strength & security



Long lasting & corrosion resistant



Beauty & design

Energy Rating WERS



Glazing	Casement		Fixed	
	U	SHGC	U	SHGC
6mm Clear Toughened / 12mm Argon / 6mm Clear Toughened	4.3	0.44	3.2	0.60
6mm Energy Tech / 12mm Argon / 6mm Clear Toughened	3.9	0.38	2.5	0.52
6mm Performa Tech / 12mm Argon / 6mm Clear Toughened Grey	3.7	0.21	2.3	0.27
6mm Insulmax 564 / 12mm Argon / 6mm Clear Toughened	3.7	0.19	2.3	0.24
6mm Sunergy Clear / 12mm Argon / 6mm Clear Toughened	4.0	0.32	2.7	0.43
6.38mm Clear ComfortPlus / 12mm Argon / 6mm Clear Toughened	3.9	0.38	2.5	0.51
6mm LightBridge / 12mm Argon / 6mm Clear Toughened	3.8	0.36	2.4	0.48



Design & Build: Salerno Homes

Windows for meaningful living.



Design & Build: Salerno Homes



Design & Build: Salerno Homes

Authorised Fabricator

Thermeco
Windows for meaningful living.

15 Kelletts Road, Rowville
3178, Victoria, Australia
Phone: 03 9763 1089
Fax: 03 9923 6263
windows@thermeco.com.au

Members of:



*The images displayed on this brochure may not always exactly relate to the specified series and are used as representation only.